



# *Colwyn Chambers*

PRESTIGIOUS OFFICE ACCOMMODATION  
**TO LET • 1,099 SQ FT (102 SQ M)**



**YORK STREET • MANCHESTER**



SIXTH FLOOR  
(102 sq m) · 1,099 sq ft



PRESTIGIOUS  
OFFICE ACCOMMODATION

# Colwyn Chambers

YORK STREET · MANCHESTER

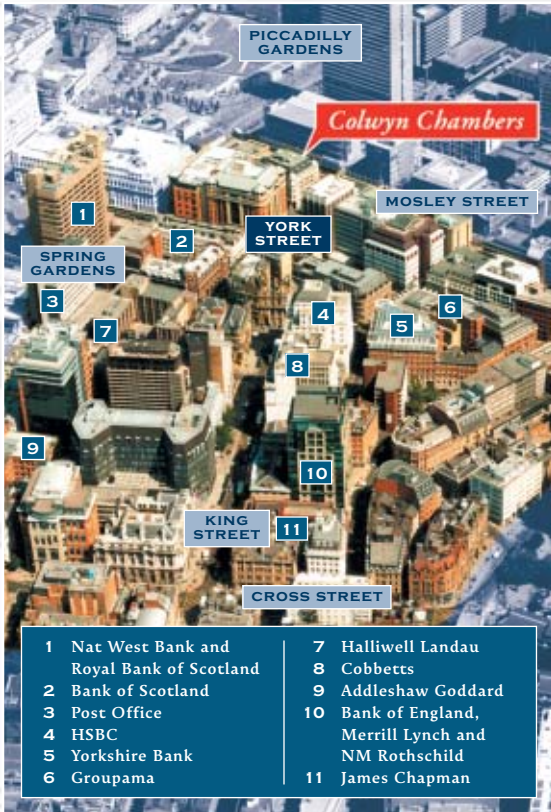

## ACCOMMODATION

The accommodation available presents an outstanding opportunity to gain an extremely prestigious, fully-fitted, penthouse-style office suite within the heart of Manchester.

## LOCATION

Situated within Manchester's financial business centre, Colwyn Chambers provides an excellent location for a professional business operation.

## SIXTH FLOOR LAYOUT

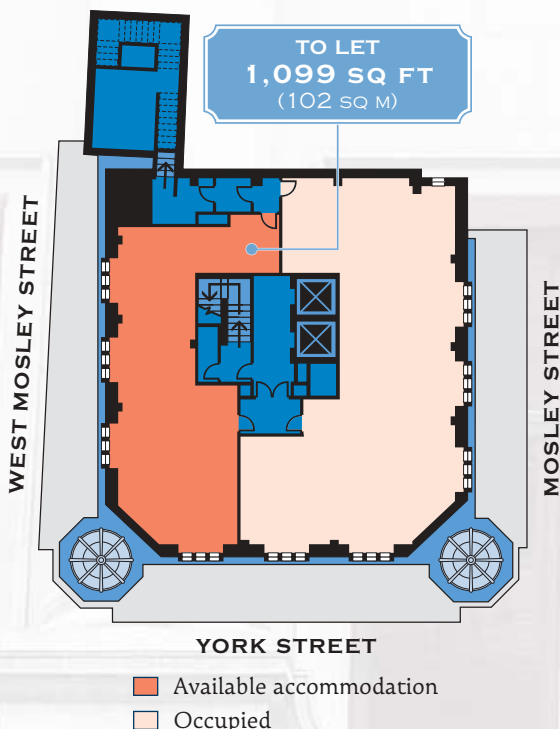

## DESCRIPTION

Each of the following features are included in this modern office building constructed behind its Grade II listed façade:

- 24-hour access control with CCTV surveillance
- House Manager on duty during normal office hours
- Impressive entrance foyer and staircase
- Comfort cooling
- Double glazed
- Two 10-person passenger lifts, each serving the six floors
- Raised floors with triple compartment outlets
- Suspended ceilings and Category II recessed lighting

## LEASE AND RENTAL TERMS

The accommodation is available on Flexible Lease terms, details of which are available on request.



**EMERSON**  
Management Services  
A MEMBER OF THE EMERSON GROUP

01625 588230  
www.emerson.co.uk



**MISREPRESENTATION ACT:**  
Whilst the statements contained in these Particulars are given in good faith, as a general guide to the property, they do not form part of an offer or contract. Neither the Vendor/Lessor nor Agents can accept responsibility for them and any interested party must satisfy themselves by inspection or otherwise as to the correctness of these Particulars (May 2004).