

# Parkway Three

Parkway Business Centre

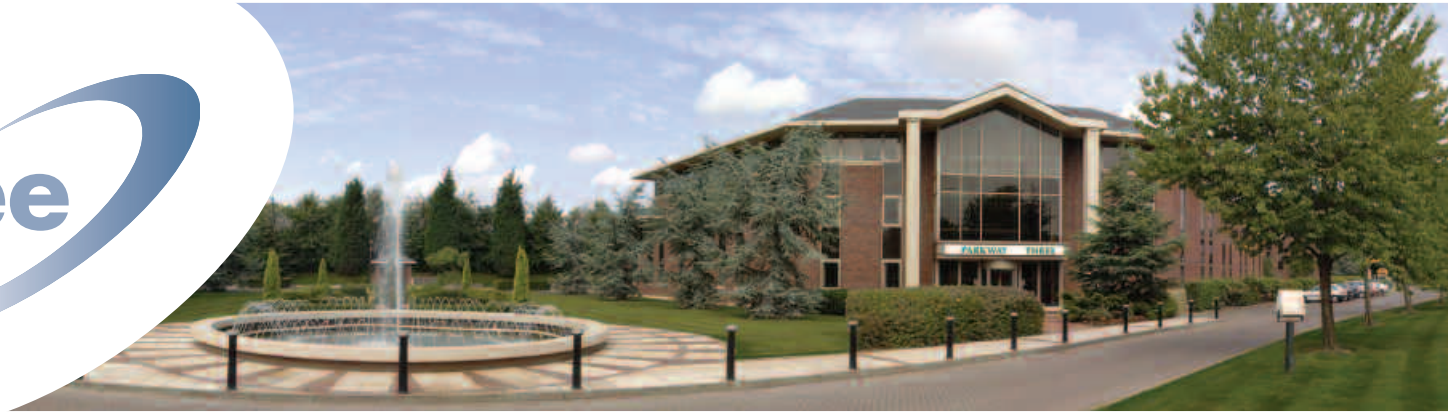

## High Quality Offices **TO LET**

The specification of this office building can be tailored to individual requirements

### Description

Parkway Three provides a total of 25,000 sqft (2,323 sqm) within the very successful Parkway Business Centre.

Car parking is located to the front and rear of the building offering an outstanding ratio of one space for every 250 sqft (23 sqm).



### Specification

#### Internal features

- Comfort cooling and heating
- Full accessed raised floors
- Suspended ceilings with category 2 lighting
- 2x 8 person passenger lift
- Impressive ground floor reception area
- High quality finishes throughout
- Kitchen facility
- Male, female and disabled toilets

#### External Features

- Powder coated aluminium framed double glazed windows with anti-glare coating
- Attractive external environment with a balanced mix of hard and soft landscaping

For more information or to arrange a viewing contact:

**Orbit**  
**Developments**  
 A MEMBER OF THE EMERSON GROUP  
 01625 588200  
 www.orbit-developments.co.uk

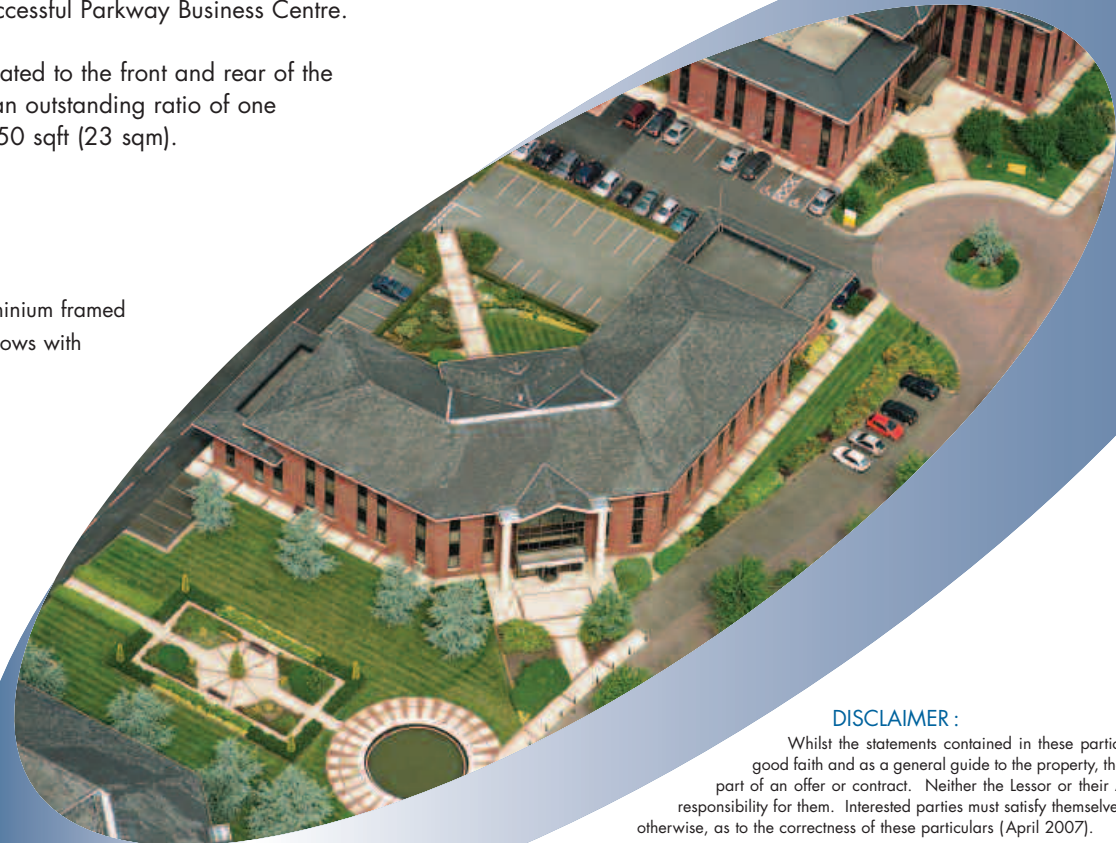

#### DISCLAIMER :

Whilst the statements contained in these particulars are given in good faith and as a general guide to the property, they do not form any part of an offer or contract. Neither the Lessor or their Agents can accept responsibility for them. Interested parties must satisfy themselves by inspection, or otherwise, as to the correctness of these particulars (April 2007).

# Parkway Three

Parkway Business Centre



## Ground Floor

South Wing  
Café/Service offices

North Wing  
Suites from  
462 sqft  
(43 sqm)

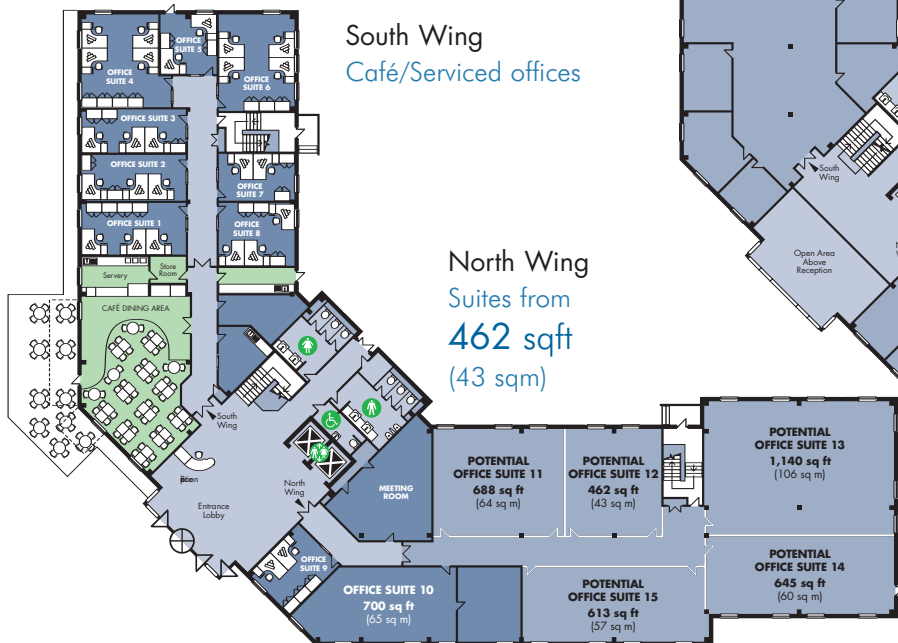

## First Floor

South Wing  
3,650 sqft  
(339 sqm)

North Wing  
5,400 sqft  
(502 sqm)

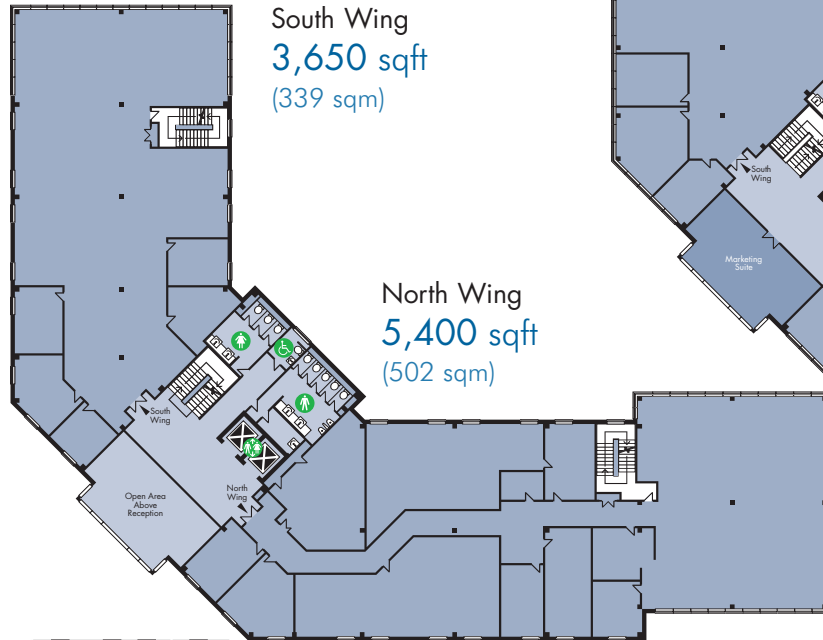

## Second Floor

South Wing  
2,760 sqft  
(256 sqm)

North Wing  
3,640 sqft  
(338 sqm)

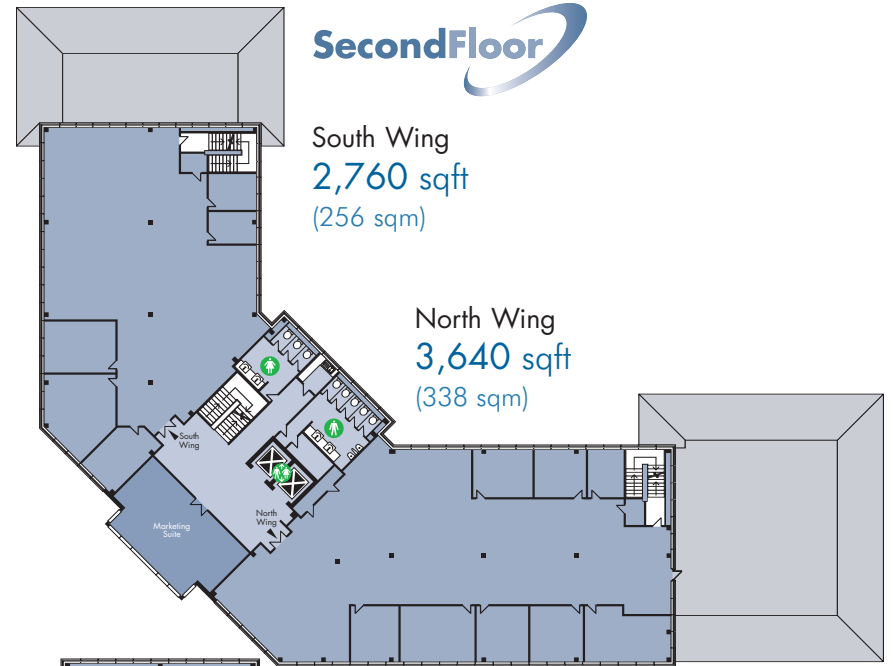

Typical Office Area

